

KY TYPE 70

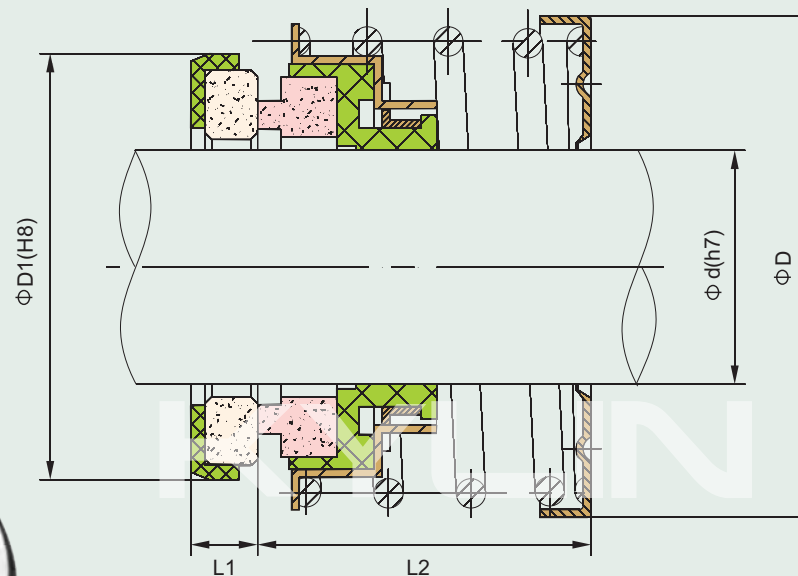

Part#	d	D	D1	L1	L2
KY TYPE 70-15	15	31.5	29.5	8	18/24
KY TYPE 70-16	16	31.5	29.5	8	18/24
KY TYPE 70-20	20	37	35	5	15
KY TYPE 70-25	25	44.2	40	5.5	16.5
KY TYPE 70-30	30	48.6	45	6	18
KY TYPE 70-35	35	54	50	6.5	19.5
KY TYPE 70-40	40	60.4	58	7.5	20.5

Elastomer Bellows Shaft Seals

Combined Materials

- Stationary Ring (Ceramic/SiC/TC)
- Rotary Ring (Carbon/SiC/TC)
- Secondary Seal (NBR/EPDM/Viton)
- Spring and Punched Parts (Steel)

Working Conditions

- Pumps: Submersible pumps and common multi-stage deep well pumps.
- Temperature: $-20^{\circ}\text{C} \sim 110^{\circ}\text{C}$
- Pressure: $\leq 0.8\text{MPa}$
- Speed: $\leq 10\text{ m/Sec}$

▪ Add: A1001, Hebang Building, No.933 Tiantong North Road, Ningbo, China 315100

▪ Tel: +86-134-56162828

▪ Fax: +86-574-89069223

▪ Email: sales@kyltd.com